

ROCKET QUILTERS BLOCK OF THE MONTH
MAY, RELIGIOUS CENTER

①

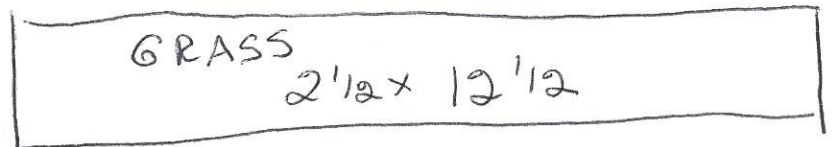
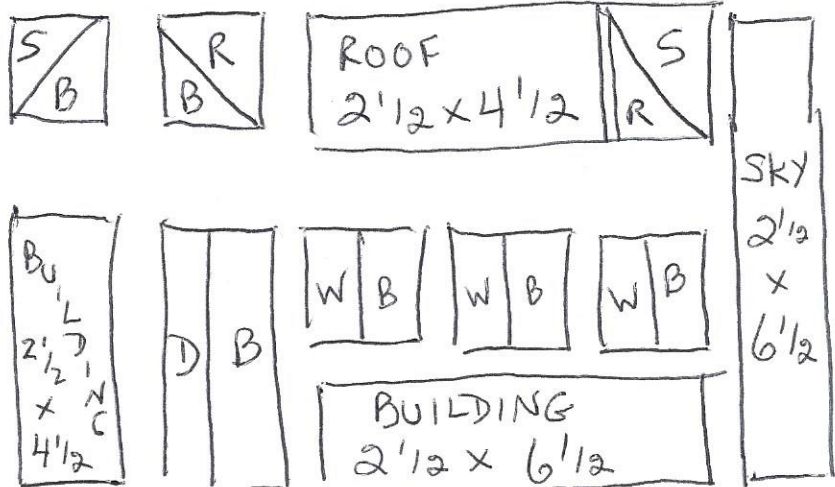
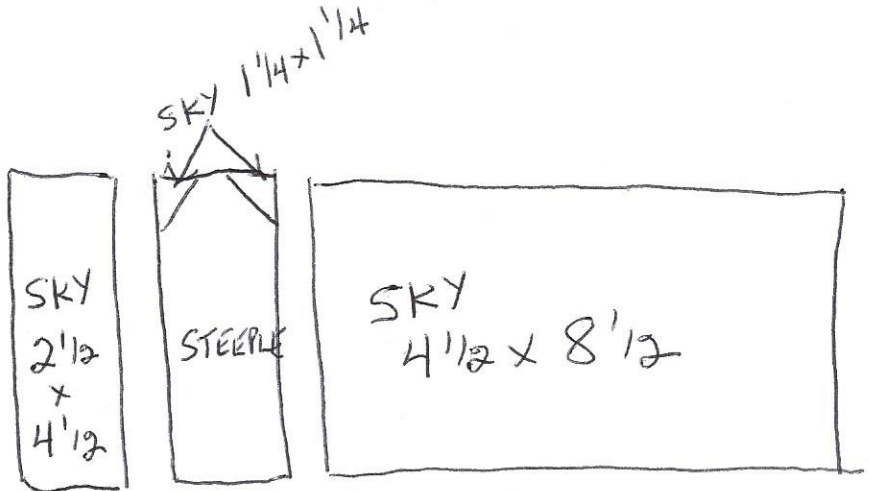
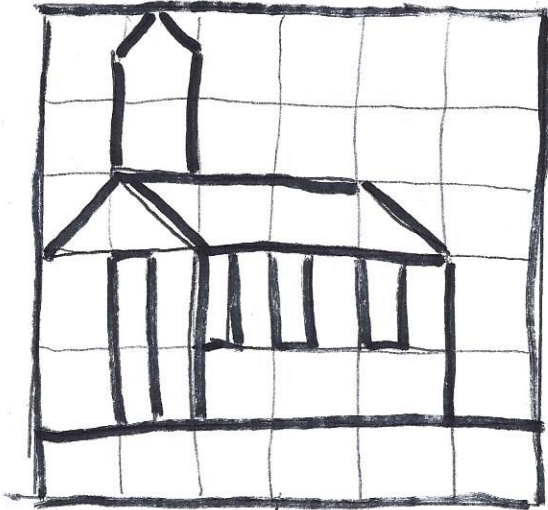

PIECES NEEDED TO BE CUT

GRASS: One $2\frac{1}{2}'' \times 12\frac{1}{2}''$

SKY: Two $2\frac{1}{2}'' \times 2\frac{1}{2}''$

Two $1\frac{1}{4}'' \times 1\frac{1}{4}''$

One $2\frac{1}{2}'' \times 6\frac{1}{2}''$

One $2\frac{1}{2}'' \times 4\frac{1}{2}''$

One $4\frac{1}{2}'' \times 8\frac{1}{2}''$

Steeple: One $2\frac{1}{2}'' \times 4\frac{1}{2}''$

Roof: Two $2\frac{1}{2}'' \times 2\frac{1}{2}''$

One $2\frac{1}{2}'' \times 4\frac{1}{2}''$

Door: One $2\frac{1}{2}'' \times 4\frac{1}{2}''$

Windows: Three $2\frac{1}{2}'' \times 2\frac{1}{2}''$

Building: Five $2\frac{1}{2}'' \times 2\frac{1}{2}''$

Two $2\frac{1}{2}'' \times 4\frac{1}{2}''$

One $2\frac{1}{2}'' \times 6\frac{1}{2}''$

S = SKY
R = ROOF
B = BLDG
W = WINDOW

1. Sew 1/14" x 1 1/4" sky pieces to the top two corners of the steeple.

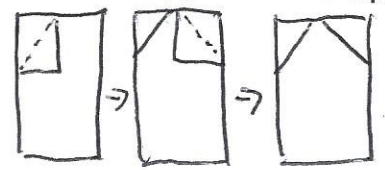

2. Sew one 2 1/2" x 2 1/2" SKY piece to one @ 1/2" x 2 1/2" BUILDING piece. Place right sides together and sew across diagonally. Open, trim, you should have a 2 1/2" x 2 1/2" half square triangle.

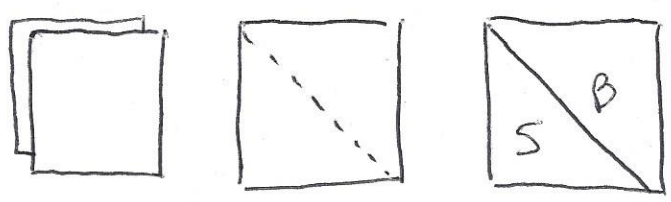

3. Repeat #2, above, with one 2 1/2" x 2 1/2" ROOF piece and one 2 1/2" x 2 1/2" BUILDING piece

4. Repeat #2, above, with one 2 1/2" x 2 1/2" SKY piece and one 2 1/2" x 2 1/2" ROOF piece.

5. Sew the 2 1/2" x 4 1/2" DOOR piece to one 2 1/2" x 4 1/2" BUILDING piece. Lay the right sides together and sew a straight line down the center in the 4 1/2" direction. Open and trim. You should have a 2 1/2" x 4 1/2" piece.

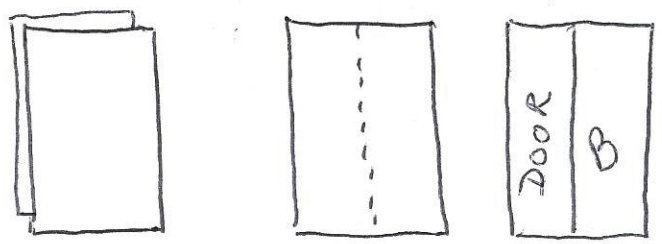

6. Sew the three 2 1/2" x 2 1/2" WINDOW pieces individually to three 2 1/2" x 2 1/2" BUILDING pieces. Place each WINDOW piece right sides together with a BUILDING piece. Sew a line straight up and down through the middle. Open and trim. You should have three 2 1/2" x 2 1/2" squares.

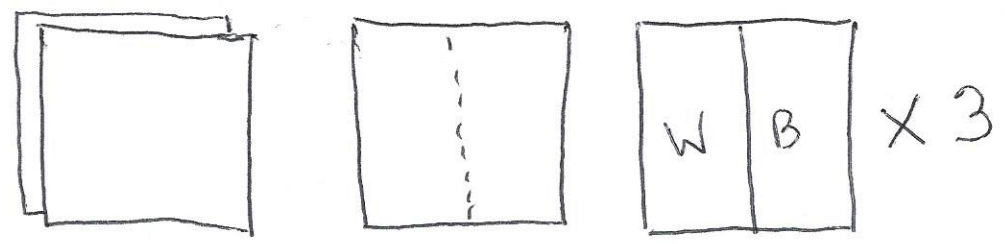

7. Layout the blocks as shown on Page 1.

- Sew the 3 WINDOW/BUILDING 2 1/2" squares together in a row.

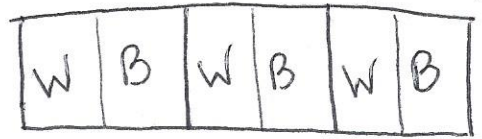

- Sew the row of WINDOW/BUILDING squares to the top of the 2 1/2" x 6 1/2" BUILDING piece

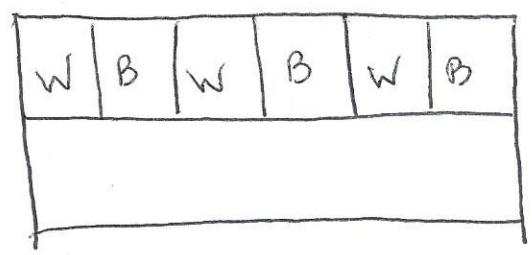

- Sew the remaining $2\frac{1}{2}$ " x $4\frac{1}{2}$ " BUILDING piece to the DOOR/BUILDING piece along the $4\frac{1}{2}$ " side, keeping the DOOR in the center. See diagram.

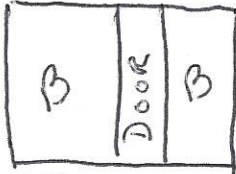

- Sew the $2\frac{1}{2}$ " x $4\frac{1}{2}$ " SKY piece to the STEEPLE along the $4\frac{1}{2}$ " edge, keeping the "dky" corners at the top. Sew this to the $4\frac{1}{2}$ " x $8\frac{1}{2}$ " BUILDING piece, along the $4\frac{1}{2}$ " side.

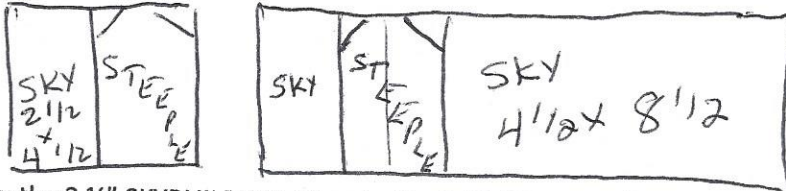

- Sew the $2\frac{1}{2}$ " SKYBUILDING piece to the $2\frac{1}{2}$ " BUILDING/ROOF square, matching the BUILDING sides. See Diagram to make sure your layout is right. Sew the $2\frac{1}{2}$ " x $4\frac{1}{2}$ " ROOF piece to this, along the ROOF edge. See Diagram to make sure your layout is correct. Now sew the $2\frac{1}{2}$ " SKY/ROOF square to the end,, sewing together your ROOF sides. See the diagram to make sure your layout is correct.

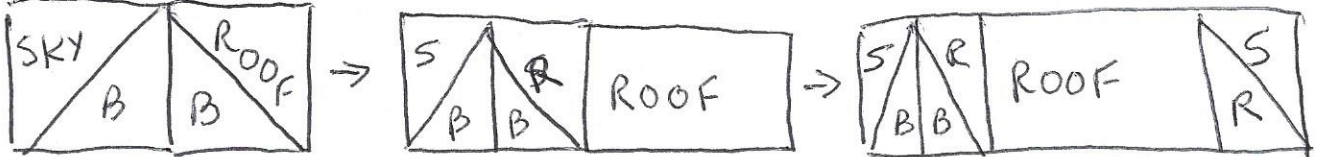

- Sew this "ROOF" row to the top of the WINDOWS and DOOR row. See the diagram to make sure your layout is correct when you sew. The ROOF line should be above the WINDOWS, the BUILDING edges above the DOOR.

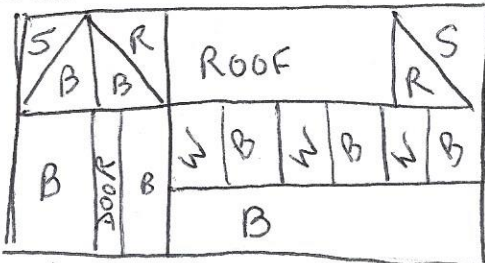

- Sew the remaining $2\frac{1}{2}$ " x $6\frac{1}{2}$ " SKY piece to the right end side of the ROOF/WINDOWS/BUILDING block you just formed. See Diagram.

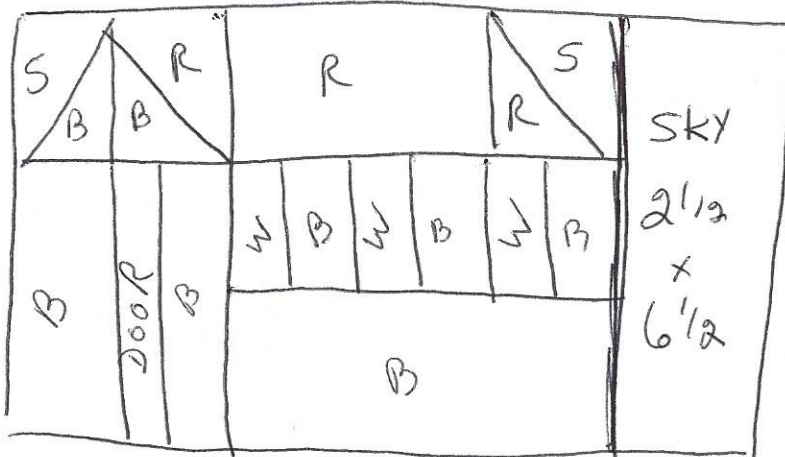

Lay these 3 rows out according to the diagram. Sew together. All done!!